

ISO WALL CLAMPS, MILD STEEL, ZINC PLATED

- * MATERIAL: MILD STEEL
- * BAKEABLE TO 150° C

ORDER CODE	NW	A	B	C
ISO63/100WCMS	63/100	23	M8	34
ISO160/250WCMS	160/250	23	M10	35

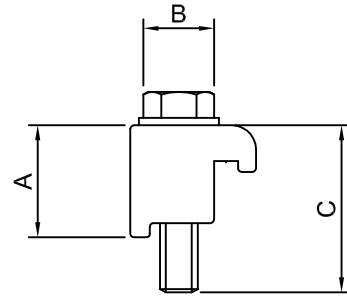

ISO WALL CLAMPS, STAINLESS STEEL

- * MATERIAL: STAINLESS STEEL
- * BAKEABLE TO 150° C

ORDER CODE	NW	A	B	C
ISO63/100WCSS	63/100	23	M8	34
ISO160/250WCSS	160/250	23	M10	35

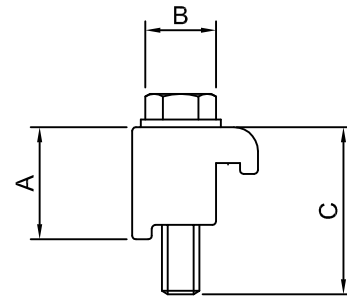

ISO WALL CLAMPS, used with o'ring, MILD STEEL, ZINC PLATED

- * MATERIAL: MILD STEEL
- * BAKEABLE TO 150° C

ORDER CODE	NW	A	B	C
ISO63/100WCO	63/100	23	M8	29
ISO160/250WCO	160/250	23	M10	33

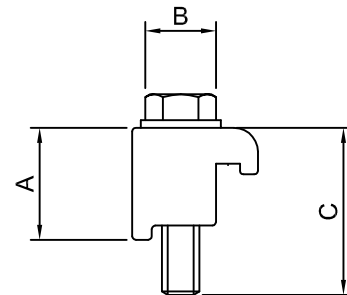

ISO WALL CLAMPS, ALUMINIUM

- * MATERIAL: ALUMINIUM
- * BAKEABLE TO 150° C

Used with blind tapped holes and centering ring

ORDER CODE	NW	A	B	C
ISO63/100WCA	63/100	23.5	M8	34
ISO160/250WCA	160/250	23.5	M10	35

