

ISO DOUBLE CLAW CLAMPS, ALUMINIUM

- * MATERIAL: ALUMINIUM
- * BAKEABLE TO 150° C

ORDER CODE	NW	A	B
ISO63/100DCA	63/100	50	M8
ISO160/100DCA	160/250	52	M10
ISO320/500DCA	320/500	68	M12

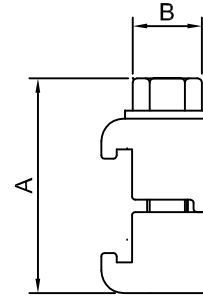

ISO STAINLESS STEEL CENTERING RING, VITON O'RING,

- * MATERIAL: STAINLESS STEEL & VITON
- * BAKEABLE TO 100°C
- * VACUUM RATING 1x10⁻⁹ mbar

ORDER CODE	NW	A	B	C
ISO63SVCR	63	8	3.9	70
ISO80SVCR	80	8	3.9	83
ISO100SVCR	100	8	3.9	102
ISO160SVCR	160	8	3.9	153
ISO200SVCR	200	8	3.9	213
ISO250SVCR	250	8	3.9	261
ISO320SVCR	320	14	5.6	318
ISO400SVCR	400	14	5.6	400
ISO500SVCR	500	14	5.6	501
ISO630SVCR	630	14	5.6	651

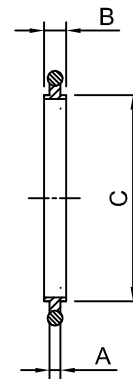

ISO ALUMINIUM CENTERING RING, VITON O'RING,

- * MATERIAL: ALUMINIUM & VITON
- * BAKEABLE TO 100°C
- * VACUUM RATING 1x10⁻⁹ mbar

ORDER CODE	NW	A	B	C
ISO63AVCR	63	8	3.9	70
ISO80AVCR	80	8	3.9	83
ISO100AVCR	100	8	3.9	102
ISO160AVCR	160	8	3.9	153
ISO200AVCR	200	8	3.9	213
ISO250AVCR	250	8	3.9	261
ISO320AVCR	320	14	5.6	318
ISO400AVCR	400	14	5.6	400
ISO500AVCR	500	14	5.6	501
ISO630AVCR	630	14	5.6	651

